

Geo Referenced Cadastral Map of Macarxendo Mining Lease, bearing T.C. No. 9 of 1949, situated in South Maulinguem Village of Bicholim Taluka, North Goa District, Goa State.

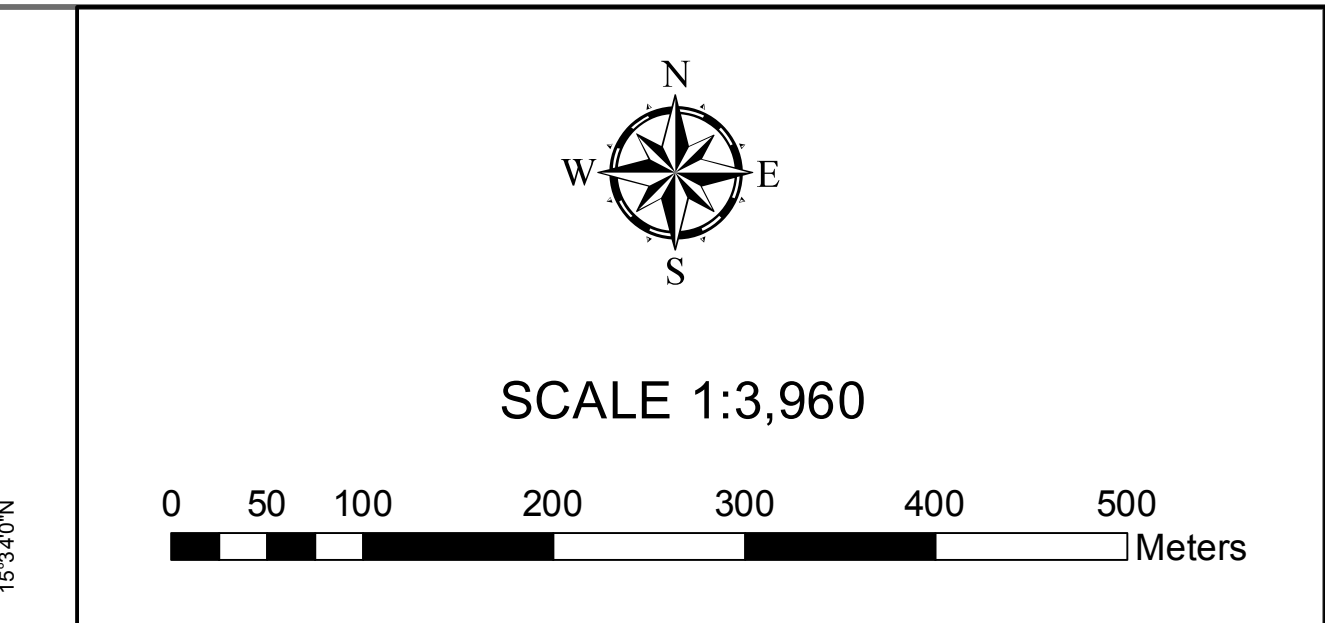

Legend

- DGPS POINT OF LEASE BOUNDARY
- ▭ LEASE BOUNDARY AS PER DGPS SURVEY
- ▭ ADJACENT LEASE BOUNDARY
- SURVEY No BOUNDARY
- SUB-DIVISION OF THE SURVEY No
- - - TALUKA BOUNDARY
- - - VILLAGE BOUNDARY

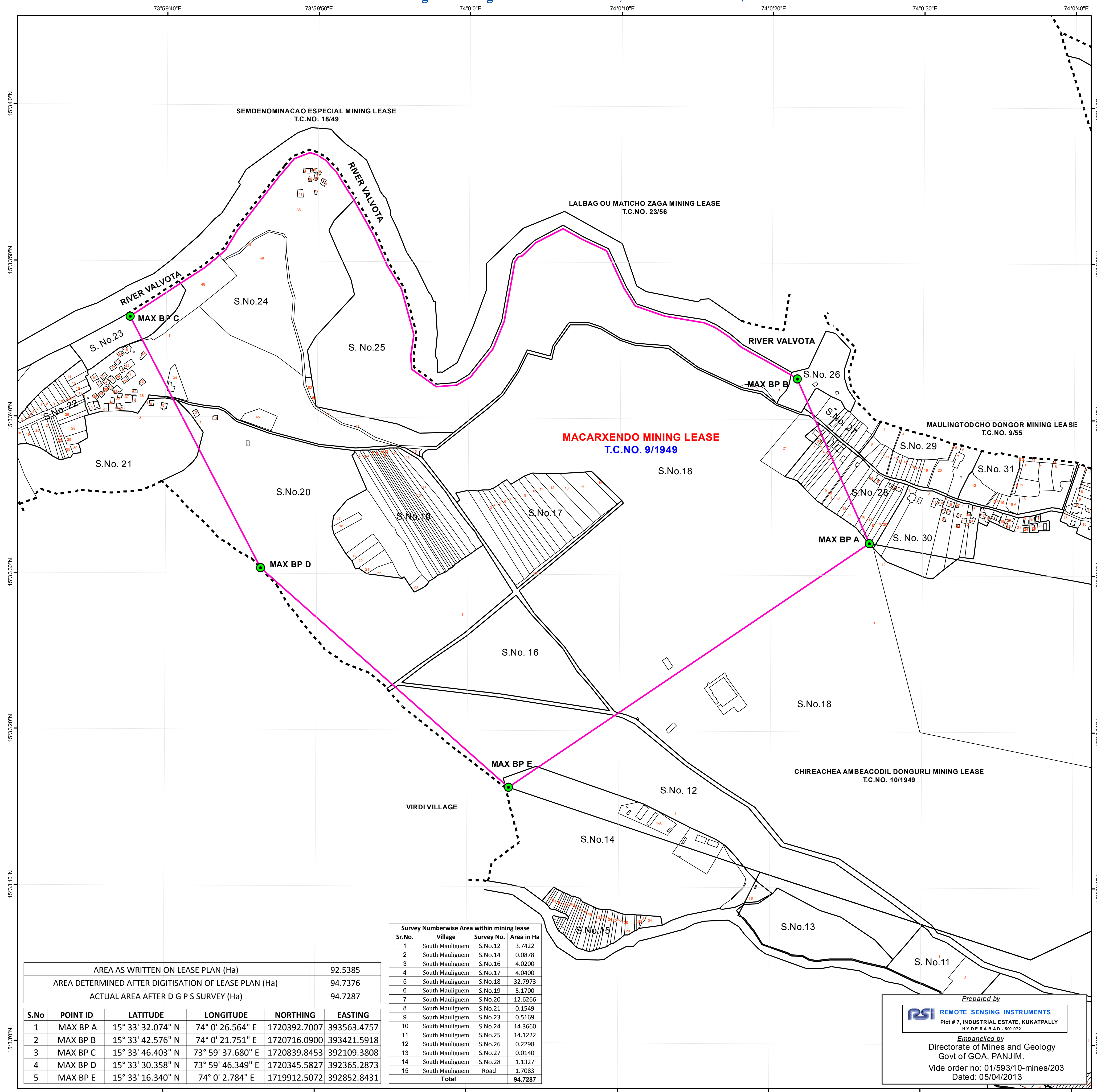
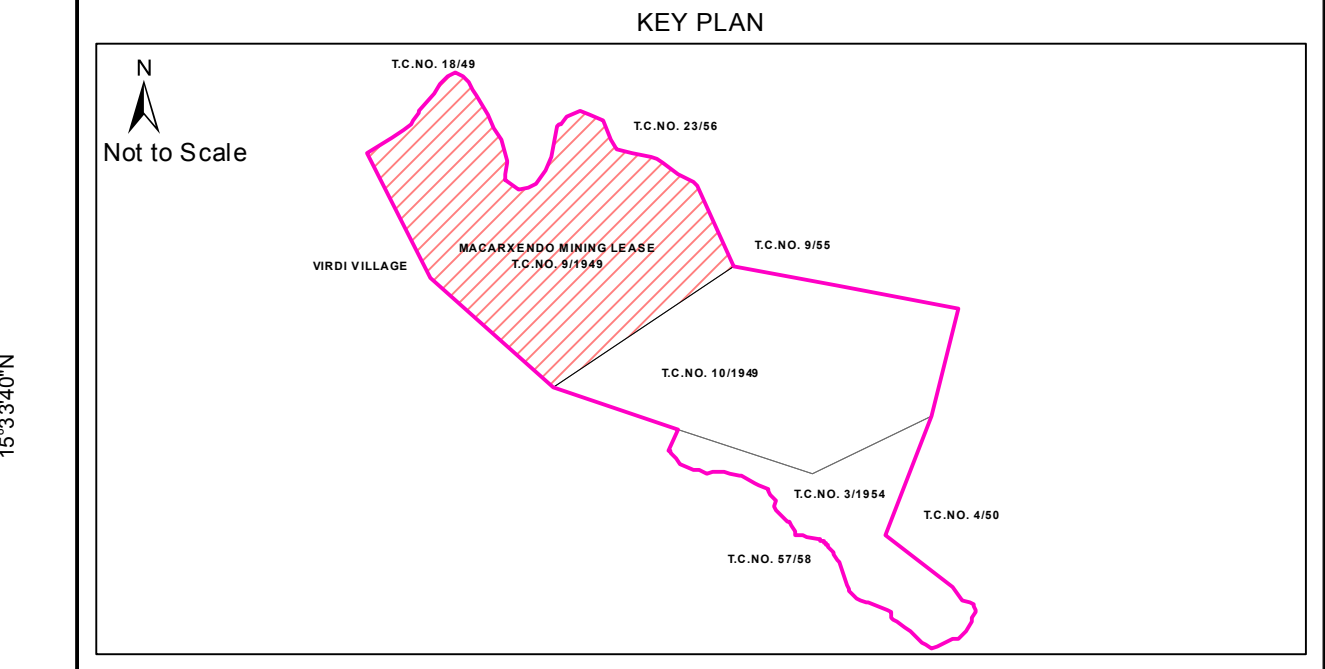

DATUM : WGS 84
PROJECTION : UTM_Zone_43N

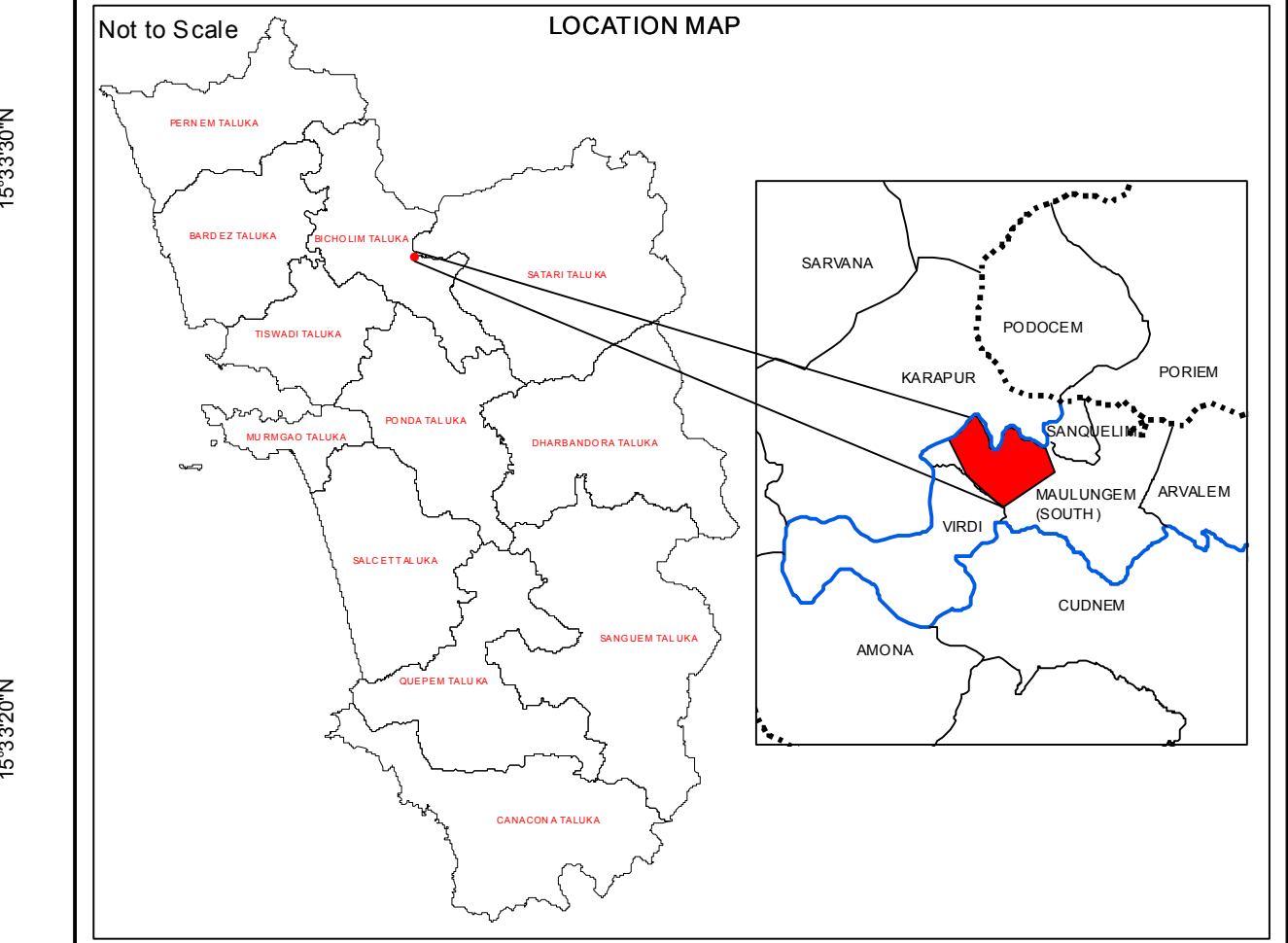

CERTIFICATE

This is to certify that the lease boundary pillars of T. C. No.9 of 1949 have been surveyed using DGPS (Differential Global Positioning System) and is based upon the Total Station survey conducted earlier.

Mr.Nassir Shaikh
(Mines Manager)

Note:
Sanquelim Mine is consisting of 3 contiguous leases bearing T C No. 10/49, 9/49 & 3/54.

CERTIFICATE

This is to certify that the lease boundary pillars of T.C. No. 9 of 1949, shown by Mr.Nassir Shaikh (Mines Manager) has been surveyed by our team led by Shri. Ch. Sivaiah using DGPS (Differential Global Positioning System) instruments. The lease map and pillar locations have been verified, survey conducted and plans prepared as per requirement of IBM Circular No. 2/2010 dated 6-4-2010.

For Remote Sensing Instruments
Shri. B.V Ramana Kumar
(General Manager)

| | |
|--|-------------------------------|
| Directorate of Mines and Geology - Panaji -Goa | |
| Checked by | Certified by |
| Surveying officer | Director of Mines and Geology |

Survey Numberwise Area within mining lease

| Sr.No. | Village | Survey No. | Area in Ha |
|--------------|------------------|------------|----------------|
| 1 | South Maulinguem | S.No.12 | 3.7422 |
| 2 | South Maulinguem | S.No.14 | 0.0878 |
| 3 | South Maulinguem | S.No.16 | 4.0200 |
| 4 | South Maulinguem | S.No.17 | 4.0400 |
| 5 | South Maulinguem | S.No.18 | 32.7973 |
| 6 | South Maulinguem | S.No.19 | 5.1700 |
| 7 | South Maulinguem | S.No.20 | 12.6266 |
| 8 | South Maulinguem | S.No.21 | 0.1549 |
| 9 | South Maulinguem | S.No.23 | 0.5169 |
| 10 | South Maulinguem | S.No.24 | 14.3660 |
| 11 | South Maulinguem | S.No.25 | 14.1222 |
| 12 | South Maulinguem | S.No.26 | 0.2298 |
| 13 | South Maulinguem | S.No.27 | 0.0140 |
| 14 | South Maulinguem | S.No.28 | 1.1327 |
| 15 | South Maulinguem | Road | 1.7083 |
| Total | | | 94.7287 |

| | |
|---|---------|
| AREA AS WRITTEN ON LEASE PLAN (Ha) | 92.5385 |
| AREA DETERMINED AFTER DIGITISATION OF LEASE PLAN (Ha) | 94.7376 |
| ACTUAL AREA AFTER D G P S SURVEY (Ha) | 94.7287 |

| S.No | POINT ID | LATITUDE | LONGITUDE | NORTHING | EASTING |
|------|----------|-------------------|-------------------|--------------|-------------|
| 1 | MAX BP A | 15° 33' 32.074" N | 74° 0' 26.564" E | 1720392.7007 | 393563.4757 |
| 2 | MAX BP B | 15° 33' 42.576" N | 74° 0' 21.751" E | 1720716.0900 | 393421.5918 |
| 3 | MAX BP C | 15° 33' 46.403" N | 73° 59' 37.680" E | 1720839.8453 | 392109.3808 |
| 4 | MAX BP D | 15° 33' 30.358" N | 73° 59' 46.349" E | 1720345.5827 | 392365.2873 |
| 5 | MAX BP E | 15° 33' 16.340" N | 74° 0' 2.784" E | 1719912.5072 | 392852.8431 |

Prepared by
RSI REMOTE SENSING INSTRUMENTS
 Plot # 7, INDUSTRIAL ESTATE, KUKATPALLY
 HYDERABAD - 500 072
 Empanelled by
 Directorate of Mines and Geology
 Govt of GOA, PANJIM.
 Vide order no: 01/593/10-mines/203
 Dated: 05/04/2013

Date of DGPS survey: 20 May, 2013