

**Plan Showing The Lease Boundary of T. C. No. 47/54 on Geo referenced & Vectorised Cadastral Map
Sited in Village Sigao, Sanguem (Dharbandora) Taluka, South Goa Dist., Goa.**

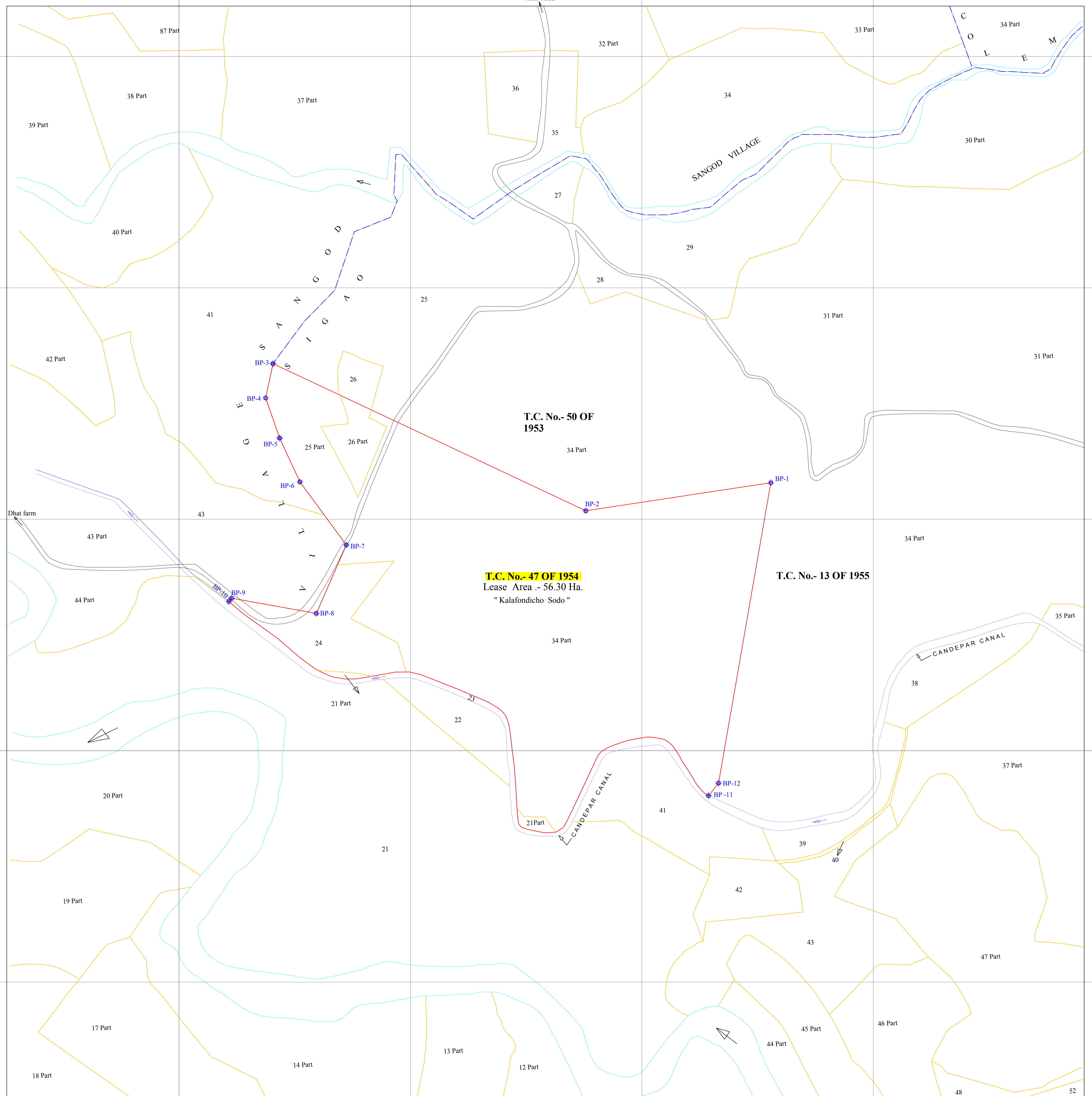

T.C. No.- 50 OF 1953

T.C. No.- 47 OF 1954
Lease Area - 56.30 Ha.
" Kalafondicho Sodo "

T.C. No.- 13 OF 1955

B.P.No.	LATITUDE	LONGITUDE	EASTING	NORTHING
1	15° 20' 46.3196" N	74° 11' 38.1039" E	413478.6680	1696778.9030
2	15° 20' 44.2998" N	74° 11' 24.7025" E	413078.8460	1696718.3330
3	15° 20' 54.5615" N	74° 11' 01.9970" E	412403.0170	1697036.1860
4	15° 20' 52.1489" N	74° 11' 01.4752" E	412387.1790	1696962.1120
5	15° 20' 49.3251" N	74° 11' 02.4995" E	412417.3950	1696875.2320
6	15° 20' 46.2537" N	74° 11' 03.9817" E	412461.2330	1696780.6900
7	15° 20' 41.8319" N	74° 11' 07.3599" E	412561.4520	1696644.4420
8	15° 20' 37.0099" N	74° 11' 05.2065" E	412496.6850	1696496.5150
9	15° 20' 38.0600" N	74° 10' 59.0647" E	412313.6720	1696529.4740
10	15° 20' 37.8264" N	74° 10' 58.8681" E	412307.7820	1696522.3180
11	15° 20' 24.3003" N	74° 11' 33.6770" E	413344.1480	1696102.8070
12	15° 20' 25.1799" N	74° 11' 34.3964" E	413365.7020	1696129.7540

Survey Number-wise area within Mining Lease		
Village	Survey No.	Area (Ha.)
Sigao	21 part	0.3251
Sigao	24	4.0500
Sigao	25 Part	4.1925
Sigao	26 Part	1.4732
Sigao	34 Part	46.0445
Sigao	Road	0.2147
TOTAL		56.3000 Ha.

LEGEND	
	LEASE BOUNDARY PILLARS
	LEASE BOUNDARY
	VILLAGE BOUNDARY
	SURVEY NO. BOUNDARY
	ROAD
	NALLA / RIVER
	CANDEPAR CANAL

