

VIJAY V.CHOWGULE FOR LEGAL HEIRS OF LATE SHRI V.D.CHOWGULE, CHOWGULE HOUSE, MORMUGAO HARBOUR-GOA.
Geo Referenced Cadastral Map of Oiteiros Que Ficam De Ambos Lados Etc Mining Lease, bearing T.C. No. 40 of 1950,
situated in Santana Village of Sanguem Taluka, South Goa District, Goa State.

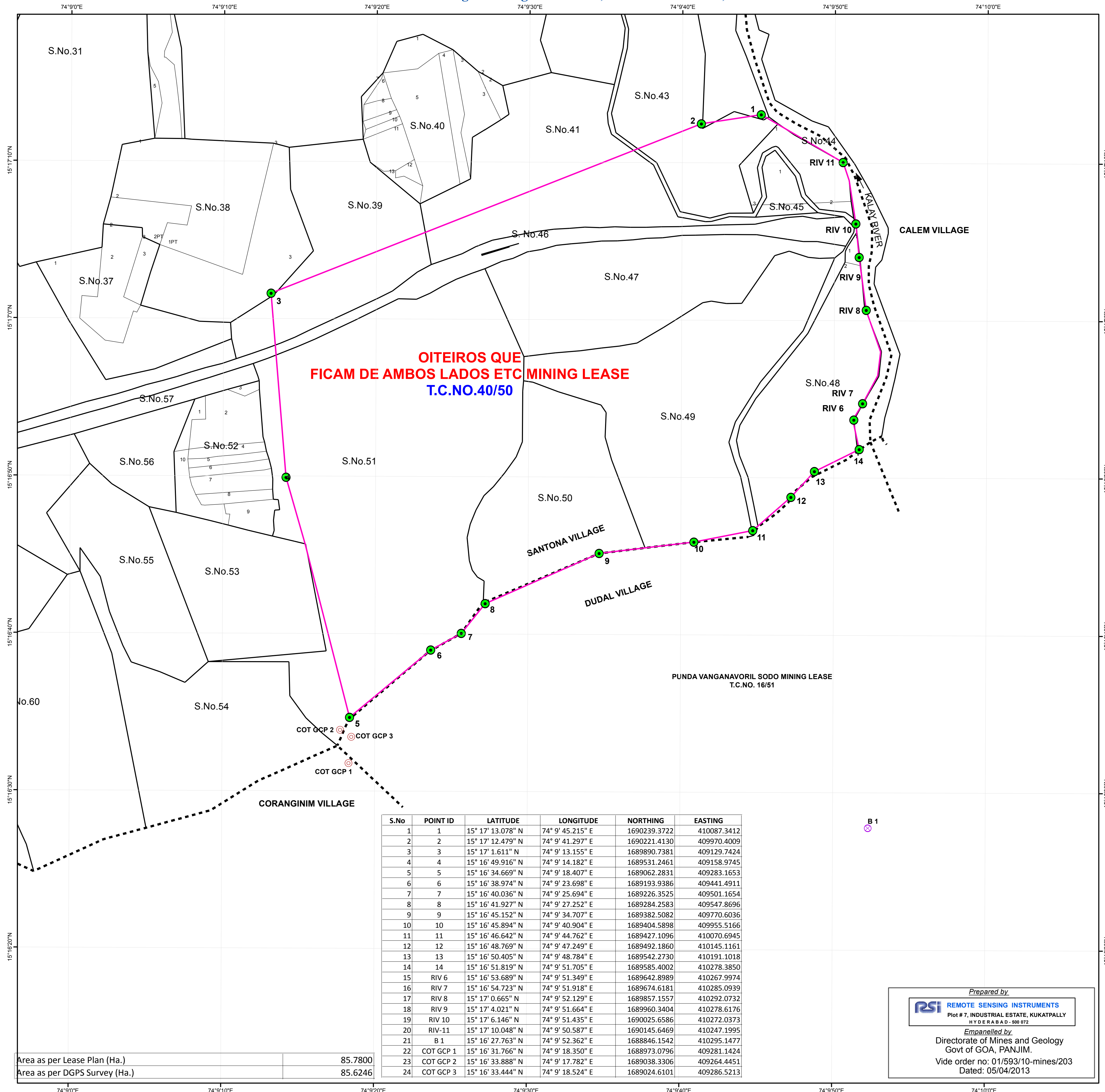

**OITEIROS QUE
 FICAM DE AMBOS LADOS ETC MINING LEASE
 T.C.NO.40/50**

S.No	POINT ID	LATITUDE	LONGITUDE	NORTHING	EASTING
1	1	15° 17' 13.078" N	74° 9' 45.215" E	1690239.3722	410087.3412
2	2	15° 17' 12.479" N	74° 9' 41.297" E	1690221.4130	409970.4009
3	3	15° 17' 1.611" N	74° 9' 13.155" E	1689890.7381	409129.7424
4	4	15° 16' 49.916" N	74° 9' 14.182" E	1689531.2461	409158.9745
5	5	15° 16' 34.669" N	74° 9' 18.407" E	1689062.2831	409283.1653
6	6	15° 16' 38.974" N	74° 9' 23.698" E	1689193.9386	409441.4911
7	7	15° 16' 40.036" N	74° 9' 25.694" E	1689226.3525	409501.1654
8	8	15° 16' 41.927" N	74° 9' 27.252" E	1689284.2583	409547.8696
9	9	15° 16' 45.152" N	74° 9' 34.707" E	1689382.5082	409770.6036
10	10	15° 16' 45.894" N	74° 9' 40.904" E	1689404.5898	409955.5166
11	11	15° 16' 46.642" N	74° 9' 44.762" E	1689427.1096	410070.6945
12	12	15° 16' 48.769" N	74° 9' 47.249" E	1689492.1860	410145.1161
13	13	15° 16' 50.405" N	74° 9' 48.784" E	1689542.2730	410191.1018
14	14	15° 16' 51.819" N	74° 9' 51.705" E	1689585.4002	410278.3850
15	RIV 6	15° 16' 53.689" N	74° 9' 51.349" E	1689642.8989	410267.9974
16	RIV 7	15° 16' 54.723" N	74° 9' 51.918" E	1689674.6181	410285.0939
17	RIV 8	15° 17' 0.665" N	74° 9' 52.129" E	1689857.1557	410292.0732
18	RIV 9	15° 17' 4.021" N	74° 9' 51.664" E	1689960.3404	410278.6176
19	RIV 10	15° 17' 6.146" N	74° 9' 51.435" E	1690025.6586	410272.0373
20	RIV-11	15° 17' 10.048" N	74° 9' 50.587" E	1690145.6469	410247.1995
21	B 1	15° 16' 27.763" N	74° 9' 52.362" E	1688846.1542	410295.1477
22	COT GCP 1	15° 16' 31.766" N	74° 9' 18.350" E	1688973.0796	409281.1424
23	COT GCP 2	15° 16' 33.888" N	74° 9' 17.782" E	1689038.3306	409264.4451
24	COT GCP 3	15° 16' 33.444" N	74° 9' 18.524" E	1689024.6101	409286.5213

Area as per Lease Plan (Ha.) 85.7800
 Area as per DGPS Survey (Ha.) 85.6246

Prepared by
RSI REMOTE SENSING INSTRUMENTS
 Plot # 7, INDUSTRIAL ESTATE, KUKATPALLY
 HYDERABAD - 500 072
 Empanelled by
 Directorate of Mines and Geology
 Govt of GOA, PANJIM.
 Vide order no: 01/593/10-mines/203
 Dated: 05/04/2013

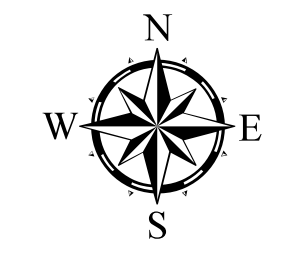

SCALE 1:3,960

300
 1 Meters

- Legend**
- DGPS POINT OF LEASE BOUNDARY
 - ▭ LEASE BOUNDARY AS PER DGPS SURVEY
 - SURVEY No BOUNDARY
 - SUB-DIVISION OF THE SURVEY No
 - - - VILLAGE BOUNDARY
 - ⊗ BASE STATION
 - ⊙ GROUND CONTROL POINTS

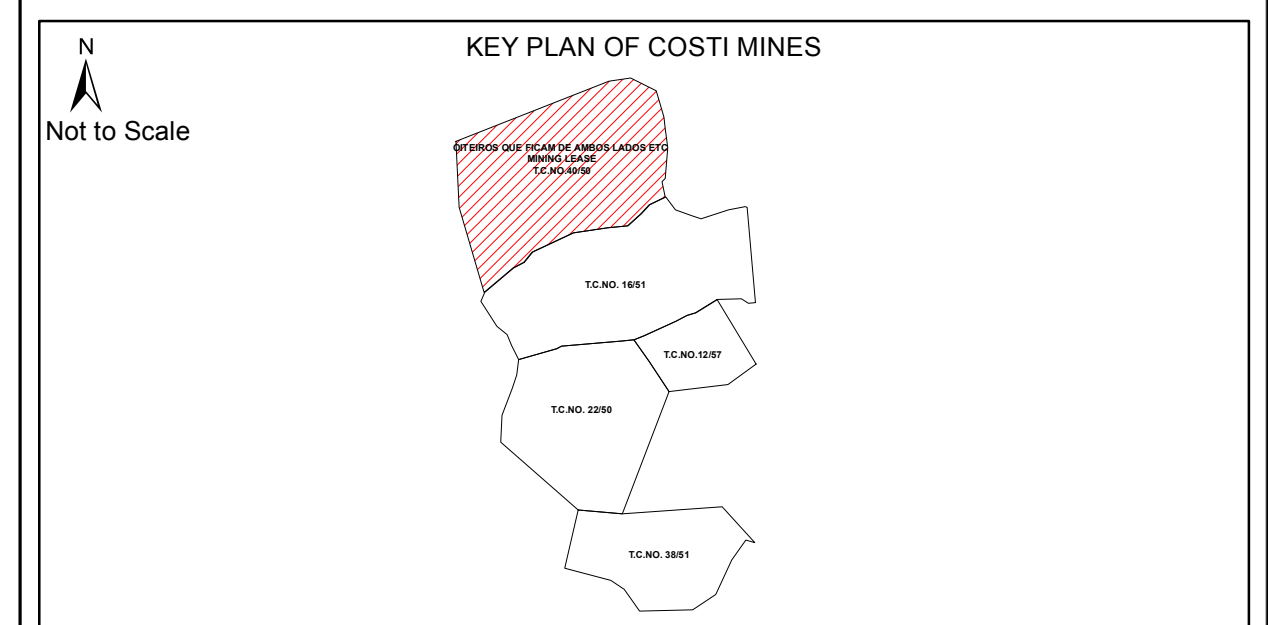

DATUM : WGS 84
 PROJECTION : UTM_Zone_43N

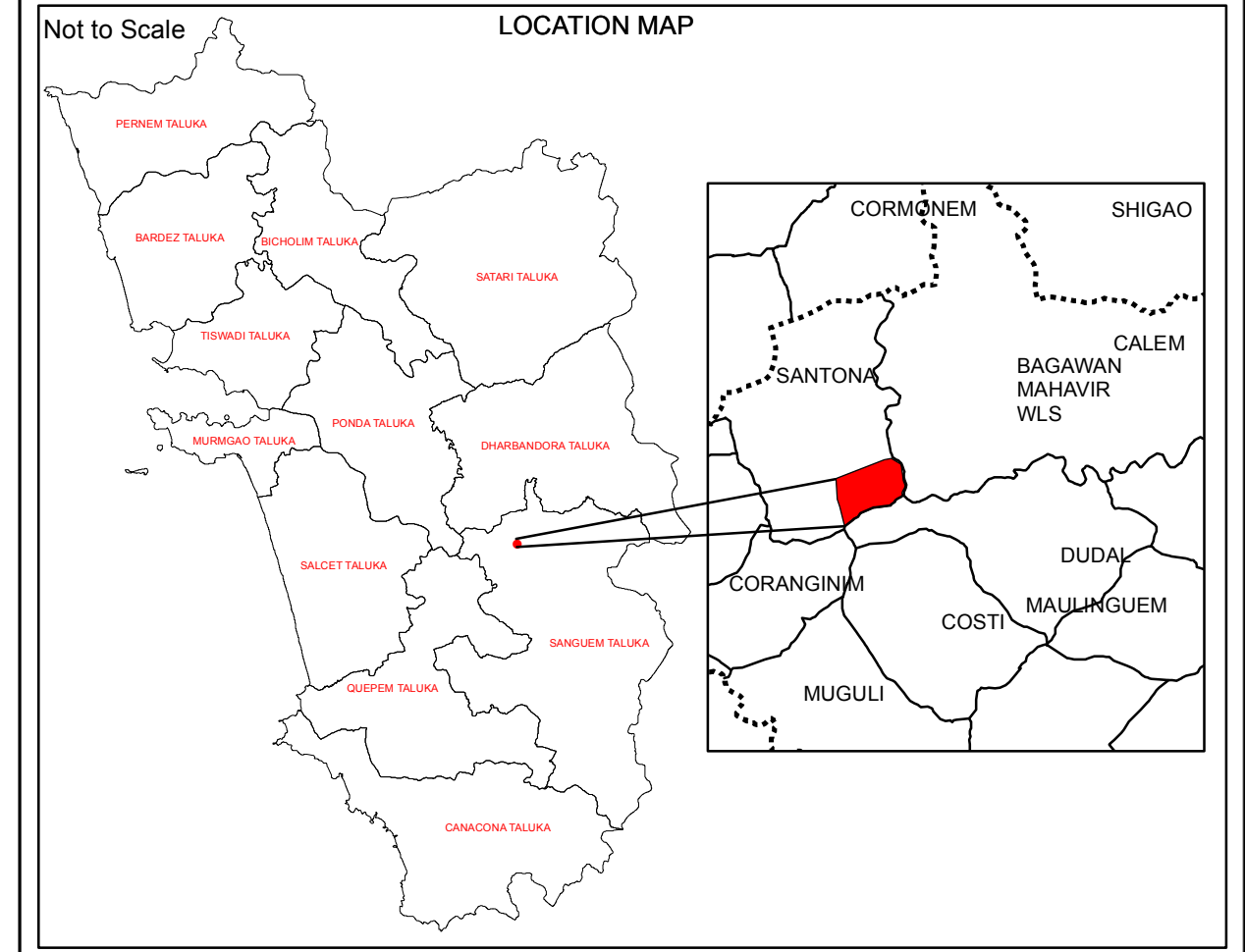

Certificate by Mines Manager

This is to certify that the lease boundary pillars of T.C. No. 40 of 1950 have been surveyed and fixed on the ground by using Total Station and the same are surveyed by using DGPS (Differential Global Positioning System).

Mr.V.M.KANTAK
 (Mines Manager)

Certificate by Accredited Agency

This is to certify that the lease boundary pillars of T.C.No. 40 of 1950, shown by Mr.V.M.KANTAK (Mines Manager) has been surveyed by our team led by Shri.Ch Sivaiah using DGPS (Differential Global Positioning System) instruments. The lease map and pillar locations have been verified, survey conducted and plans prepared as per requirement of IBM circular No. 2/2010 dated 06-04-2010.

For Remote Sensing Instruments
 Shri. B.V Ramana Kumar
 (General Manager)

Directorate of Mines and Geology - Panaji -Goa	
Checked by	Certified by
Surveying officer	Director of Mines and Geology

Date of DGPS survey: 29th & 30th May, 2013